

CONTACT INFORMATION

- Website: www.supermicro.com
- General Information: marketing@supermicro.com
- Technical Support: support@supermicro.com
- Phone: +1 (408) 503-8000, Fax: +1 (408) 503-8008

FOR YOUR SYSTEM TO WORK PROPERLY, PLEASE DOWNLOAD APPROPRIATE

- DRIVERS/IMAGES/USER'S MANUAL FROM THE LINKS BELOW:
- Manuals: <http://www.supermicro.com/support/manuals>
 - Drivers & Utilities: <https://www.supermicro.com/wftp/driver/>
 - Safety: http://www.supermicro.com/about/policies/safety_information.cfm

PACKAGE CONTENTS

- One (1) Supermicro Motherboard
- One (1) I/O Shield
- One (1) Quick Reference Guide



Motherboard Layout and Features

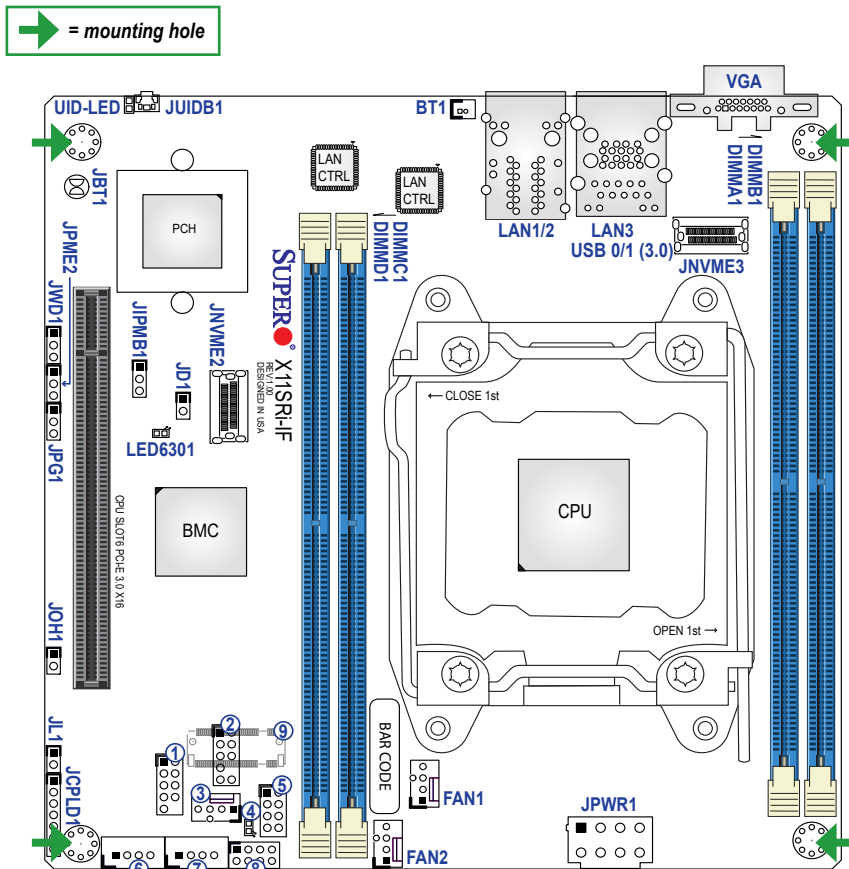

#	Description	#	Description	#	Description
1	JCOM1	4	LED1	7	JPWR3
2	JTPM1	5	JFP1	8	I-SGPIO1
3	FAN3	6	JPWR2	9	M.2-PCH (on the bottom side)

Notification for the Mounting Holes

Before assembling the motherboard, pay attention to the location of mounting holes. Please select the chassis which fits the mounting hole locations of this motherboard. Refer to the illustration below for the location details.

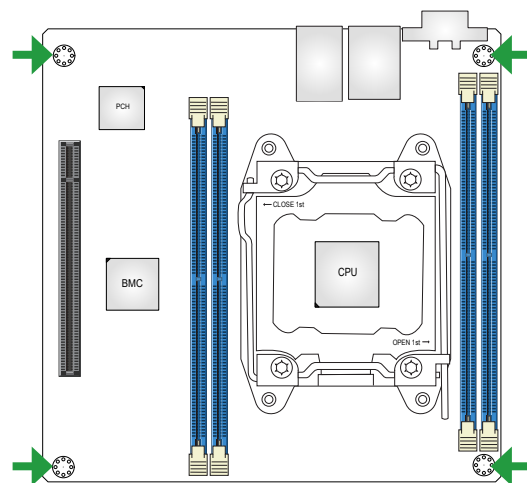

Connectors, Jumpers, and LED Indicators

Connectors	
Connector	Description
BT1	Onboard Battery Header
FAN1, FAN2	CPU/Memory Fan Headers
FAN3	System Fan Header (for Add-on Card or PCH)
I-SGPIO1	Serial Link General Purpose I/O Connection Header
JCOM1	COM Header
JD1	Speaker Header (Pin 1: positive terminal, Pin 2: negative terminal)
JFP1	Front Control Panel Connector
JIPMB1	3-pin BMC External I ² C Header (for an IPMI card)
JL1	Chassis Intrusion Header
JNVME2	Dual-function Connector for SATA 3.0 or NVMe (PCI-E 3.0 x4)
JNVME3	NVMe (PCI-E 3.0 x4) Connector
JOH1	Overheat/Fan Fail LED Header
JPWR1	8-pin ATX Power Connector
Notes:	
1. To support all the features of this motherboard, use a power supply unit with a least 500W. To support a double width add-on card on the motherboard, use a power supply unit with at least 700W.	
2. The power of this motherboard is supplied by a 12V DC-in directly. Short a wire from PS-ON# to GND on ATX-24Pin cable plug if using an ATX power supply unit.	
JPWR2, JPWR3	4-pin SATA Power Connectors
JTPM1	Trusted Platform Module (TPM)/Port 80 Connector
JUIDB1	Unit Identifier (UID) Switch
LAN1, LAN2	1GbE LAN (RJ45) Ports
LAN3	Dedicated IPMI LAN Port
	M.2 PCI-E 3.0 x4 Slot (Supports M-Key 2280)
Note: The location of M.2 slot is on the bottom side of the motherboard. To prevent the M.2 slot and the installed device from hitting the chassis, keep a 5.5mm clearance from the bottom side of the motherboard and the chassis.	
M.2-PCH	
SLOT6	CPU PCI-E 3.0 x16 Slot
USB0, USB1	Back Panel Universal Serial Bus (USB) 3.0 Ports
VGA	VGA Port

Jumpers		
Jumper	Description	Default Setting
JBT1	CMOS Clear	Open (Normal)
JPG1	VGA Enable/Disable	Pins 1-2 (Enabled)
JWD1	Watchdog Timer	Pins 1-2 (Reset)

LED Indicators		
LED	Description	Status
LED1	Onboard Power LED	Solid Green: Power On
LED6301	BMC Heartbeat LED	Blinking Green: BMC Normal
UID-LED	Unit Identifier (UID) LED	Solid Blue: Unit Identified

CPU Support

The X11SRi-IF motherboard supports an Intel® Xeon® W-2200/2100 series (Socket R4) processor with up to 18 cores and a thermal design power (TDP) of up to 165W.

Memory Support

The X11SRi-IF supports up to 256GB of RDIMM and 512GB of LRDIMM DDR4 (288-pin) ECC memory with speeds of up to 2933 MHz in four memory slots. See below for additional memory information.

Always use DDR4 memory of the same type, size, and speed. Mixed DIMM speeds can be installed. However, all DIMMs will run at the speed of the slowest DIMM.

- The motherboard supports odd-numbered modules (one or three modules installed). However, to achieve the best memory performance, a balanced memory population is recommended.
- 16Gb density DRAM module is supported by Intel Xeon W-2200 series processors.
- DDR4-2933MHz memory speed support is available with selected Intel Xeon W-2200 series processors.

1 CPU, 4-DIMM Slots	
Number of DIMMs	Memory Population Sequence
1	DIMMA1
2	DIMMA1 / DIMMC1
3 (Unbalanced: not recommended)	DIMMA1 / DIMMC1 / DIMMB1
4	DIMMA1 / DIMMC1 / DIMMB1 / DIMMD1

CPU Installation

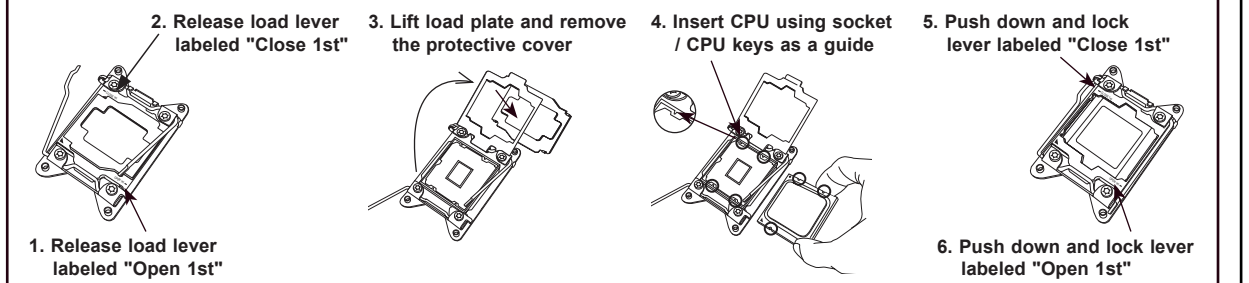

Heatsink Installation

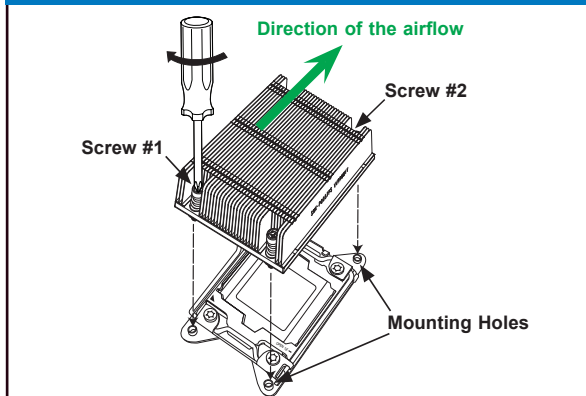

Front Control Panel (JFP1)

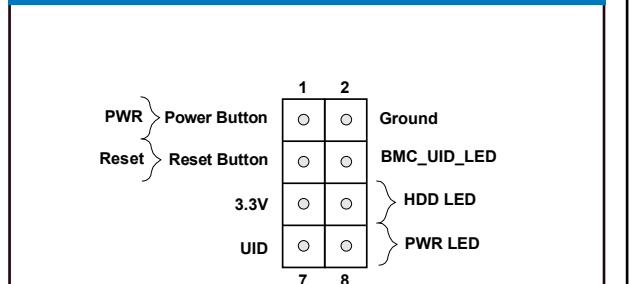

Back Panel I/O Connectors

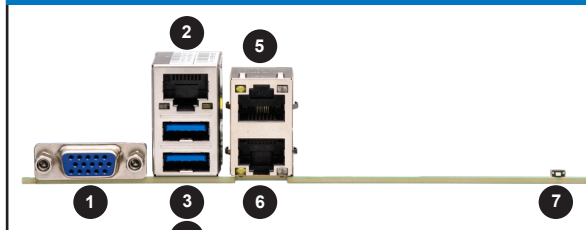

#	Description	#	Description
1	VGA Port	5	LAN1
2	Dedicated IPMI LAN (LAN3)	6	LAN2
3	USB0	7	UID Switch
4	USB1		

Note: Graphics shown in this quick reference guide are for illustration only. Your components may or may not look exactly the same as drawings shown in this guide.

Note: Refer to Chapter 1 of the User Manual for detailed information on jumpers, connectors, and LED indicators.

Note: Refer to Chapter 2 of the User Manual for detailed information on memory support and CPU/motherboard installation instructions.